

QUICK START OF ARZ SOLAR ROLLER SHUTTER

ZWP S8 remote control is supplied in one packaging with the roller shutter
 The roller shutter is factory programmed on channel No. 1 !!!

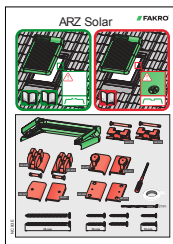

Install the roller shutter in accordance with installation instructions of NC93E

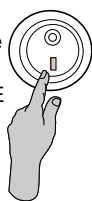

Make sure that the main switch of the roller shutter is set to channel No.1



Remove foil strip to unlock the batteries in the remote control.

Check the operation of the roller shutter unfolding.

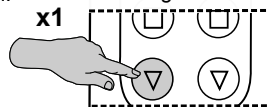

Check the operation of the roller shutter folding.

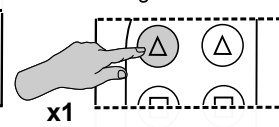

Information concerning programming, change of parameters, changes in configuration settings, calling individual functions is contained in the **Programming and Usage Instructions (code NC97C)**.

The roller shutter is equipped with the **manual operating button** positioned in its upper part. It enables control of the roller shutter in case of losing the remote control or wearing off its batteries. If after mounting the roller shutter cannot be launched via the remote control, check operation from the **manual operating button**.

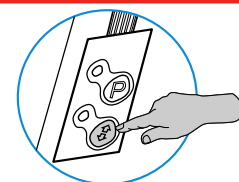

If the roller shutter works from the manual operating button, and yet it cannot be launched via remote control, make **RESET** and go to **PROGRAMMING** !!!

RESET

SIGNALLING

RESET OF THE ROLLER SHUTTER

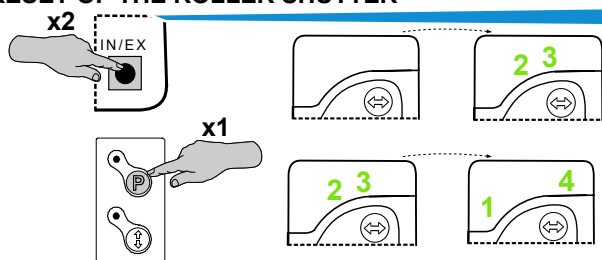

RESET OF THE REMOTE CONTROL

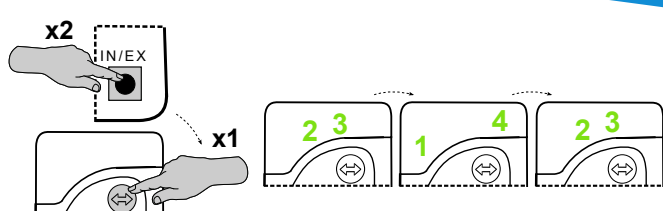

ADDITIONAL INFORMATION

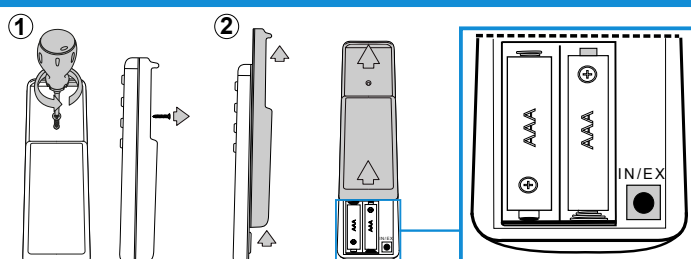

1. Screw out the screw on the back of the remote control.
2. Pull out up back part of the remote control to access IN/EX programming button.

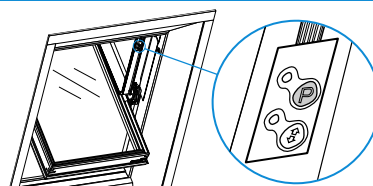

PROGRAMMING

SIGNALLING

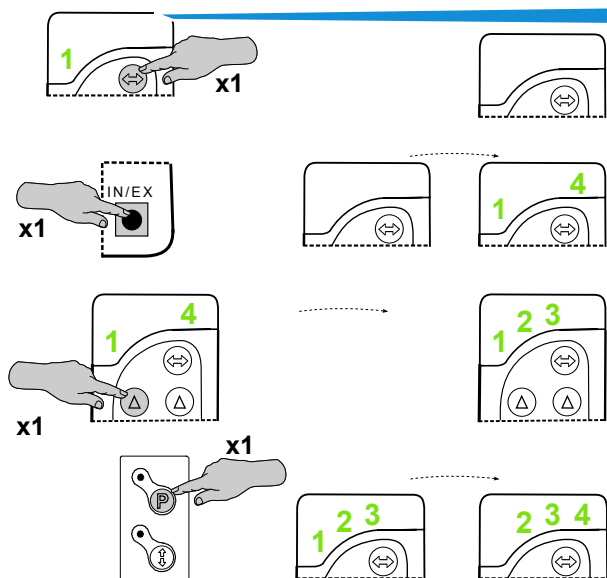

Choose one of four available channels, e.g. No.1

- 1 - channel one - control of the roller shutter No. 1 and No. 2
 - 2 - channel two - control of the roller shutter No. 3 and No. 4
 - 3 - channel three - control of the roller shutter No. 5 and No. 6
 - 4 - channel four - control of the roller shutter No.7 and No. 8
- 1 2 3 4 - common channel - control of two groups with 4 roller shutters in each

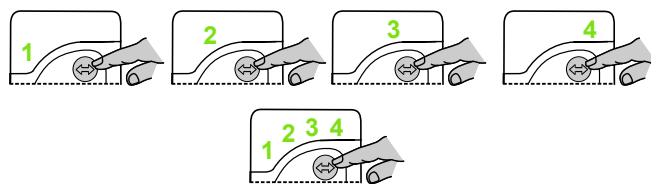

CONTROL

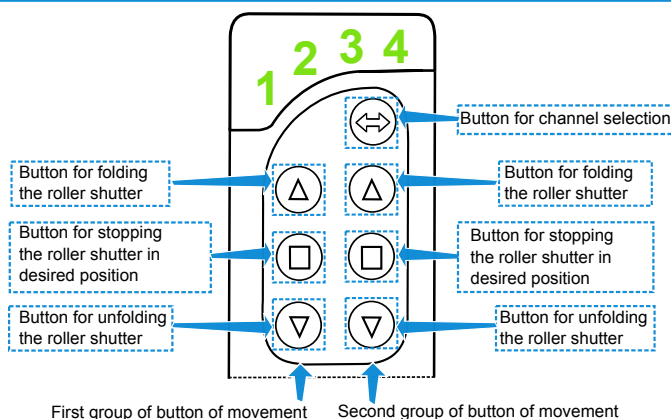
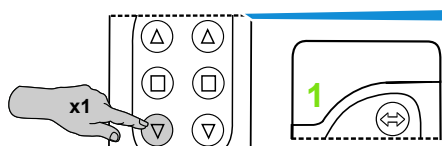

First group of button of movement Second group of button of movement

Calling other procedures such as DELETE, EXCLUDE, LEARN MODE, DEVICE CONNECTION is described in programming instructions attached to the ARZ Solar roller shutter. Information on how to perform programming of Z-Wave devices with the use of remote controllers of other manufacturers is to be found in the manuals of these devices.